

From SketchBook to Revit

Use SketchBook to capture ideas and ideate rapidly for underlays as part of the Revit workflow.

Step 1: Start in SketchBook

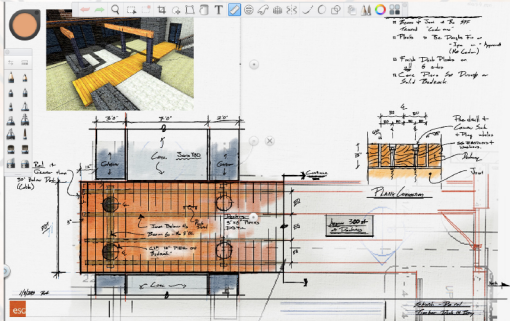

Use SketchBook's powerful features to efficiently draw an underlay.



To start from a paper sketch, use your phone or tablet to scan it with the Scan Sketch feature.

Step 2: Export Underlay as TIFF, JPG, JPEG, or PNG

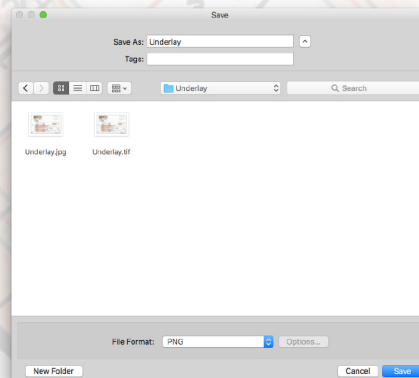

Step 3: Import to Revit

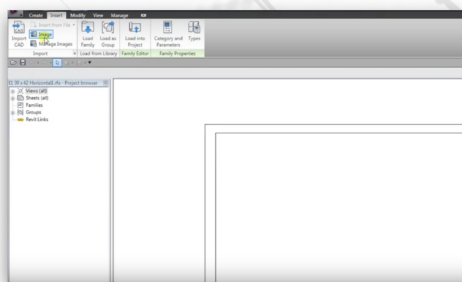

In Revit, select **Image** in the **Insert** tab to import your underlay from SketchBook.

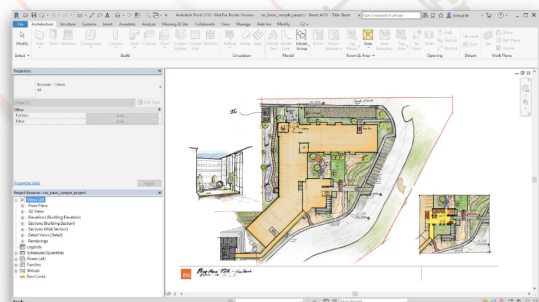

Revit accepts TIFF, JPG, JPEG, and PNG files.

From there, use your SketchBook underlay to build a model in Revit.